

# STG-900-KIT-B | Reference Guide

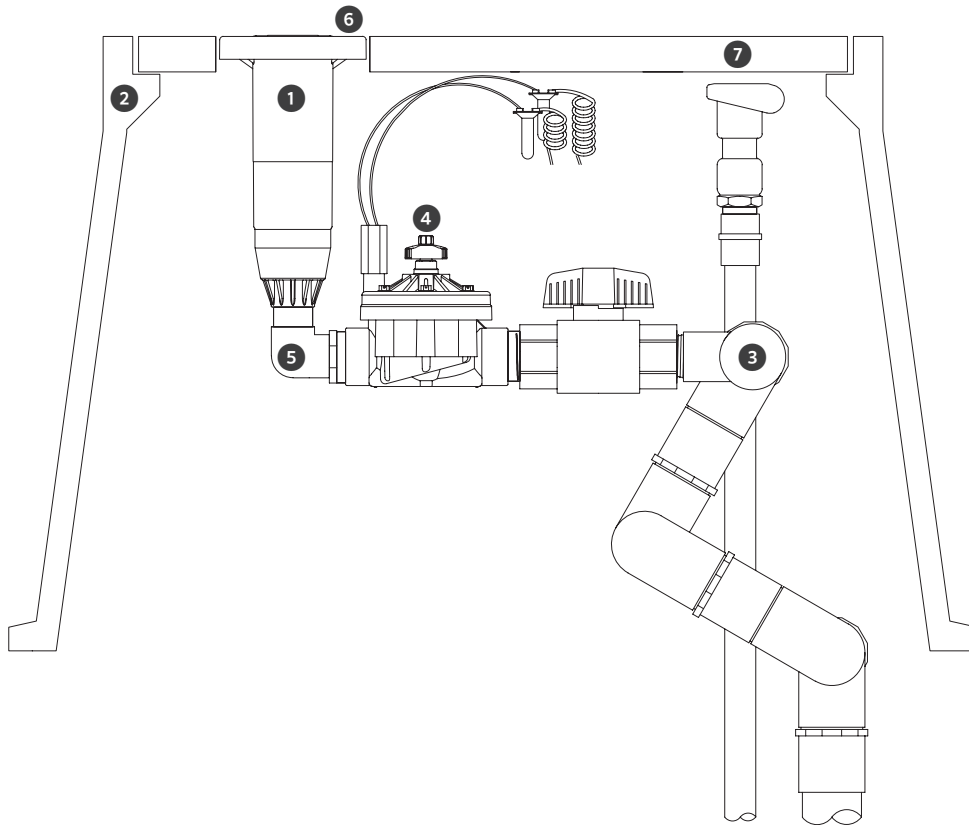

## ST-900-KIT-B Components

| FIGURE | COMPONENTS TO ORDER | QTY | ITEM DESCRIPTION   |
|--------|---------------------|-----|--|
| 1      | STG-900-83          | 1   | Pop-up, top serviceable, adjustable arc (40°-360°), 1½" (40 mm) Acme inlet   |
| 2      | ST-173026-B         | 1   | Composite vault, pre-cast hole for rotor and quick coupler   |
| 3      | ST-2008-VA          | 1   | Vertical alignment PVC swing joint, seven pivot points, 2" (50 mm) female slip inlet, 1½" (40 mm) female Acme outlet |
| 4      | ST-VBVF-K           | 1   | ICV-151G valve, manifold ball valve, 1½" (40 mm) Acme inlet, 1½" (40 mm) Acme outlet                                 |
| 5      | 239800              | 1   | 1½" (40 mm) elbow, female Acme to male Acme, connects STG-900 rotor to ST-VBVF-K                                     |
| 6      | 473900SP            | 1   | STG-900 rubber cover kit   |
| 7      | HQ-5RC-BSP          | 1   | Quick coupler, 1" (25 mm) BSP inlet, 1¼" (32 mm) outlet for key  |

**HUNTER INDUSTRIES** | *Built on Innovation®*  
 1940 Diamond Street, San Marcos, CA 92078 USA  
 hunterindustries.com