

STG-900-KIT-B / STG-900

This top-quality, long-range system is specially designed for synthetic turf sports field irrigation.

KEY BENEFITS

- Arc setting: 40° to 360°
- QuickCheck™ arc mechanism
- Through-the-top arc adjustment
- Water-lubricated gear drive
- Factory-installed rubber logo cap
- Nozzle trajectory: 22.5°

OPERATING SPECIFICATIONS

- Radius: 31.4 m to 36.6 m
- Flow: 16.9 to 20.9 m³/hr; 282 to 348 l/min
- Operating pressure range: 6.9 to 8.3 bar; 690 to 830 kPa
- Precipitation rate: 35 mm/hr approximately
- Warranty period: 5 years for component parts

USER-INSTALLED OPTIONS

- Rubber cover kit STG-900: P/N 473900SP



STG-900*

Overall height: 36 cm
Pop-up height: 8 cm
Diameter: 20 cm
Inlet size: 1½" (40 mm) Acme

*For use with the ST173026B Vault

STG-900-KIT-B

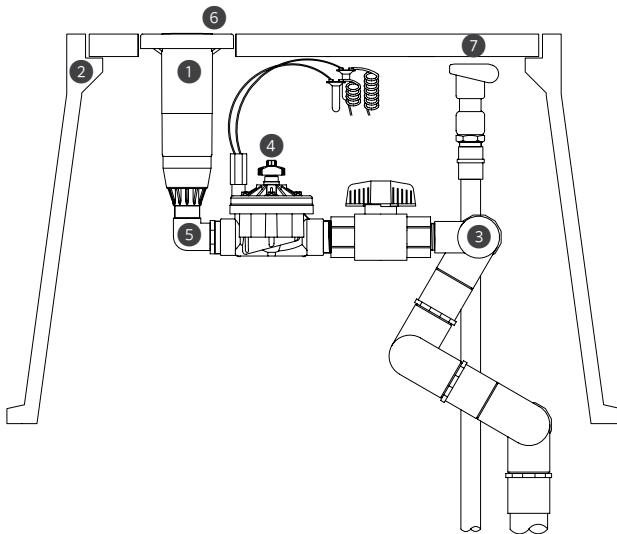

STG-900-KIT-B COMPONENTS

FIGURE	COMPONENTS	QTY	DESCRIPTION
1	STG-900-83	1	Pop-up, top serviceable, adjustable arc (40°-360°), 1½" (40 mm) Acme inlet
2	ST-173026-B	1	Composite vault, pre-cast hole for rotor and quick coupler
3	ST-2008-VA	1	Vertical alignment PVC swing joint, seven pivot points, 2" (50 mm) female slip inlet, 1½" (40 mm) female Acme outlet
4	ST-VBVF-K	1	ICV-151G valve, manifold ball valve, 1½" (40 mm) Acme inlet, 1½" (40 mm) Acme outlet
5	239800	1	1½" (40 mm) elbow, female Acme to male Acme, connects STG-900 rotor to ST-VBVF-K
6	473900SP	1	STG-900 rubber cover kit
7	HQ-5RC-BSP	1	Quick coupler, 1" BSP inlet, 1¼" outlet for key

STG-900 Rotor



STG-900 NOZZLE PERFORMANCE DATA

Nozzle	Pressure		Radius		Flow		Precip mm/hr	
	bar	kPa	m	m ³ /hr	l/min	■	▲	
73 ●	7.0	700	31.4	16.9	282	34.3	39.6	
	7.5	750	33.2	17.5	291	31.7	36.6	
Orange	8.0	800	35.1	18.1	301	29.4	34.0	
83 ●	7.0	700	34.1	19.1	319	32.8	37.9	
	7.5	750	35.4	20.0	333	32.0	37.0	
Tan	8.0	800	36.6	20.9	348	31.2	36.1	

Notes:

All precipitation rates are calculated for 180° operation.
For the precipitation rate of a 360° sprinkler, divide by 2.

Requires minimum 7.0 bar; 700 kPa dynamic pressure supplied to the swing joint inlet.

ST SWING JOINTS

Multiaxis 22 bar; 2,200 kPa rated vertical alignment PVC swing joints with seven O-ring sealed pivot points allow the rotor to be perfectly placed within the ST Vault's cover set opening.

ST2008VA: 2" (50 mm) for STG-900

Inlet: 2" (50 mm) slip*
Outlet: 1½" (40 mm) Acme

*Use P/N 241400 adapter to connect to male BSP threads

Adapter fitting 239300
Connects 239800 elbow fitting to STG-900 Acme inlet rotor

Adapter fitting 239302
Connects 239800 elbow fitting to ST-90B BSP inlet rotor



ST VALVE SETS

Heavy-duty control valves are configured to complement the ST Rotors and ST Vaults.

STVBVFK: for STG-900 in STK-2 Kit

Valve: 1½" (40 mm) NPT ICV
Ball valve: 22 bar (2,200 kPa) rating
Inlet: 1½" (40 mm) Acme
Outlet: 1½" (40 mm) Acme
Low-pressure-loss design: 0.7 bar; 70 kPa at 22.7 m³/hr; 378 l/min from swing joint inlet through to rotor
Includes: 1½" (40 mm) connection fittings



ST VAULTS

Heavy-duty tapered fibreglass and polymer-concrete construction with pre-cast holes for rotor and quick-coupler valve.

ST173026B for STG-900 includes 50 mm thick, 3-piece PC cover set

Main cover: 43 cm x 76 cm
Overall height: 66 cm
Body weight: 47 kg
Total weight: 73 kg
Base pad: 68 cm x 104 cm
Quick-access ports: 1



① Quick Coupler

All ST Vaults include convenient quick-access ports. Quick couplers provide a convenient source of water for washing down spills and water-soluble paint. The integrated in-vault design eliminates the need for additional quick-coupler enclosures.